

# Xtrafors Washdown AC Servomotors



## Features

- Smooth edges
- Stainless steel housing and shaft
- Protection IP 67

## Power

- Torque from 1.28 to 4.75 Nm

## Executions

- Wide range of standard models
- Customized versions
- Sizes 134 to 235 mm

# XtraforsWashdown, AC Servomotors

The housings of these synchronous servomotors are manufactured from stainless steel with a plain cylindrical shape. The smooth outline makes them particularly well suited for applications in food, medical, pharmaceutical and chemical industries as well as in other similar industrial branches.

## Technical data

	Rated torque [Nm]	Rated speed [rpm]	Rated current [Arms]	Peak speed Winding A		Peak speed Winding 4	
				@230VAC [rpm]	@400VAC [rpm]	Rated current [Arms]	@400VAC [rpm]
<b>BF-82</b>	1.28	6700	2.67	7450	-	1.60	7900
<b>BF-83</b>	1.70	4650	2.46	5170	8520	0.15	5100
<b>BF-122</b>	3.90	4000	4.70	4350	7550	2.57	4100
<b>BF-124</b>	4.75	4210	5.72	4350	7500	3.28	4300

## Torque curves

Winding A @230VAC

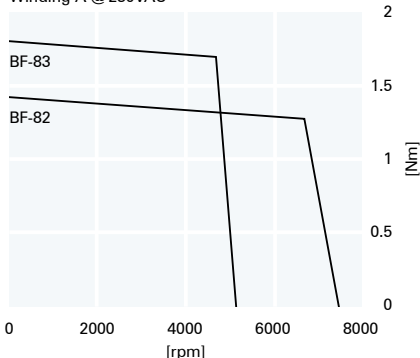

Winding A @230VAC

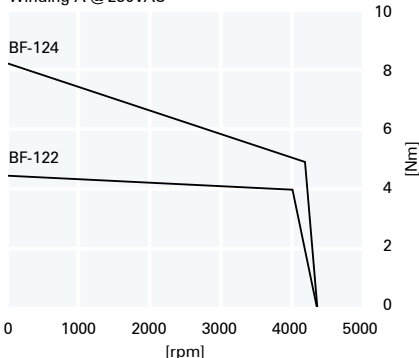

Winding A @400VAC

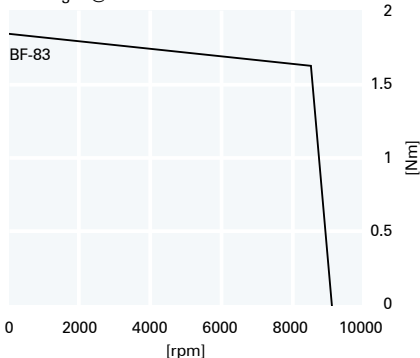

Winding A @400VAC

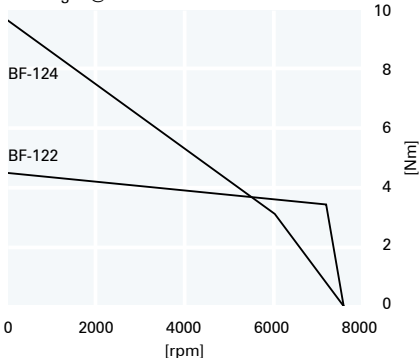

Winding 4 @400VAC

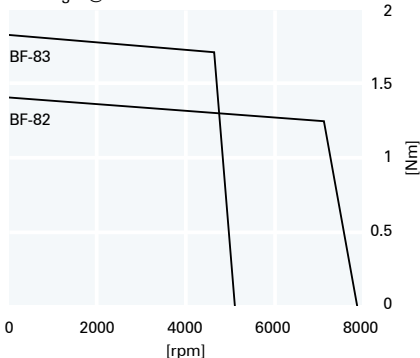

Winding 4 @400VAC

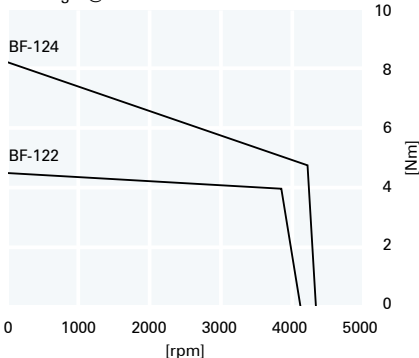

## Standard version

- Resolver feedback
- Stainless steel housing
- Stainless steel shaft
- Protection IP 67
- Direct cable output
- NTC thermal sensor
- 230VAC or 400VAC winding

## Options

- Various types of incremental encoders  
SinCos encoders, Hyperface, EndDat
- Shaft without keyway
- PTC thermal sensor

## Customized versions

- Winding

## Mechanical dimensions

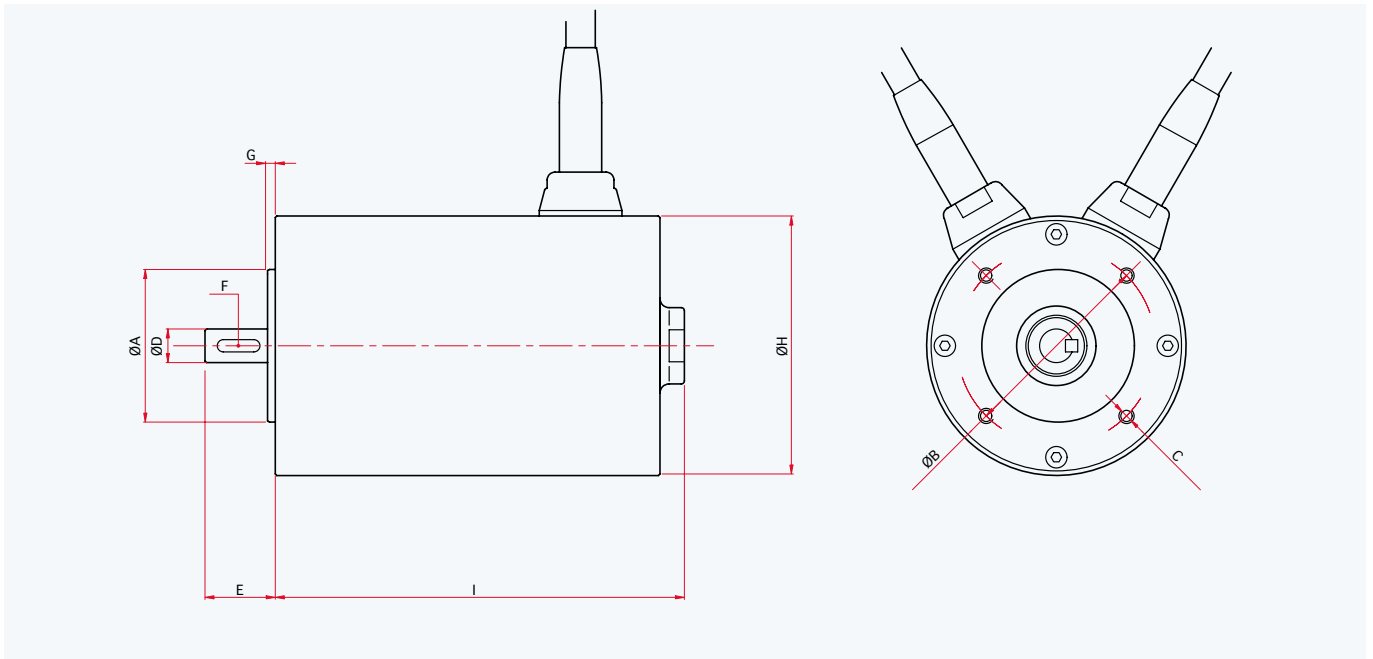

Dimensions [mm]		BF-82	BF-83	BF-122	BF-124
A Ø	j5	50	50	80	80
B Ø		65	65	100	100
C		4xM5	4xM5	4xM6	4xM6
D Ø	k6	11	11	19	19
E		23	23	40	40
F		A4x4x14	A4x4x14	A6x6x30	A6x6x30
G		2.5	2.5	3.0	3.0
H Ø		85	85	125	125
I	without brake	134	152	185	235
	with brake	158	175	206	256

## Brakes

Torque	[Nm]	1.5	3.0	8.0	12.0
Tension	[VDC]				24 (+6% - 10%)